

Wireless sockets set m-FS306

User manual

3600W



GB

Claus GmbH
Sigsfeldstr. 4
45141 Essen

www.mumbi.de

GB	Content	
	Scope of supply / Specifications.....	9
	General information / Preparation	9
	Commissioning	10
	Function check	10
	Reversing the connection (1 channel).....	10
	Reversing the connection (all channels)	11
	Notes / Tips.....	12
	Maintenance	13
	Safety and maintenance instructions	13
	Protecting the environment	13
	Declaration of Conformity	14
DE	Bedienungsanleitung	www.mumbi.de/manuals
FR	Mode d'emploi	www.mumbi.de/manuals
IT	Istruzioni per l'uso	www.mumbi.de/manuals
ES	Manual de instrucciones	www.mumbi.de/manuals

User Manual

m-FS306 - wireless sockets set

Scope of supply

- 3x wireless sockets
- 1x remote control
- 2x AAA batteries (remote control)
- Instruction

Specifications

Operating frequency:	433.92MHz
Operating range:	max. 30m (environment dependent)
Building code:	Self-teach function
Device code:	4 channels
Voltage:	230V ~ 50Hz
Power:	3600W
Battery:	2x micro 1.5V DC, AAA

General information

To ensure that you can enjoy this product for many years to come, please read this manual and store it in a safe place. The m-FS306 house management system is capable of switching connected electrical devices and lighting systems on and off with a remote control up to a distance of 30 metres. The components (remote control and wireless socket) communicate via a coded signal.

Preparation

Remove the plastic cover on the rear side of the remote control and insert the battery.

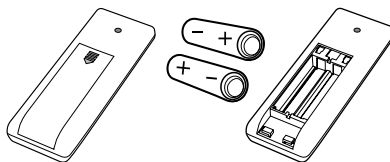

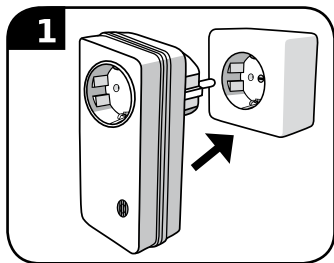

Commissioning

1. Insert the wireless socket that is to be connected to your remote control into the socket.
2. After inserting the socket and while the red LED is flashing, press one of the ON buttons on the left-hand side of the remote control, to connect the wireless socket with one of the 4 channels on the remote control (A, B, C or D).
3. The wireless socket is now connected to the remote control. You can now insert the device you wish to switch on and off into the - connected - wireless socket.

GB

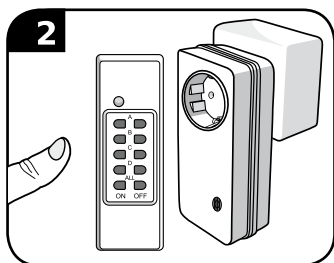

Function check

4. You can check the functionality by pressing the ON button (left-hand side) of the remote control for the previously selected letter (A, B, C or D).

If you hear a "click" sound and the LED illuminates constantly, the wireless socket is operational.

5. Then press the OFF button for the same letter on the right-hand side of the remote control.

You will hear another clearly audible "click" sound and the LED goes out.
- The wireless socket is switched off -

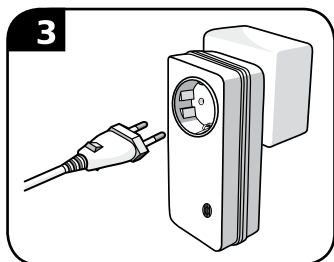

Reversing the connection (1 channel)



6. Use the respective OFF button (A, B, C or D) on the remote control to turn off the wireless socket.
7. Remove the wireless socket in question from the socket.
8. Re-insert the wireless socket into the socket.
9. Now press the OFF button for the same channel, while the red LED flashes. The red LED now flashes faster, to signal the cancelled connection.

The wireless socket can be assigned to another channel immediately, by pressing any ON button.

Reversing the connection (all channels)

6. Use the ALL-OFF button on the remote control to turn off the wireless socket.
7. Remove the wireless socket in question from the socket.
8. Now re-insert the wireless socket into the socket.
9. Now press the ALL-OFF button, while the red LED flashes. The red LED now flashes faster, to signal the cancelled connection.
10. To assign new channels, the wireless socket has to be removed and re-inserted into the socket.

Images for "Reversing the connection"

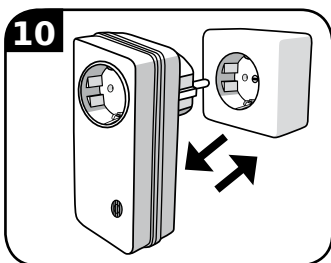
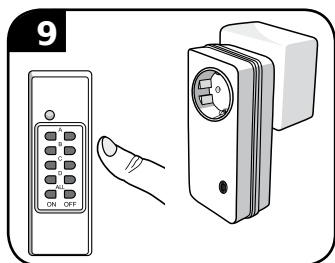
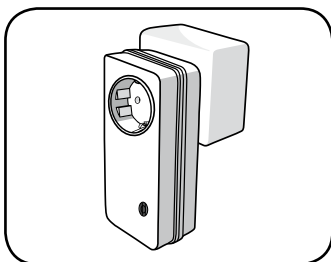
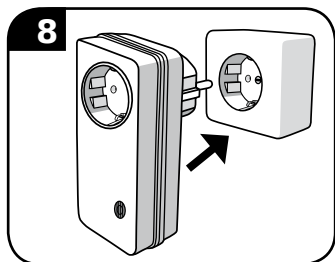
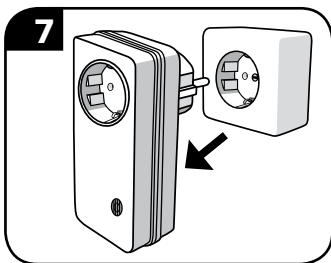
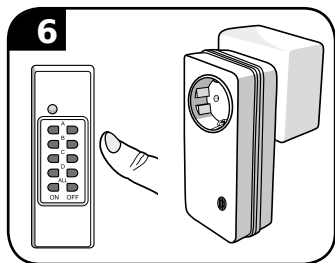

Notes

- The wireless sockets are switched on and off using the remote control (ON/OFF button).
- When the buttons are activated, the red LED on the remote control illuminates briefly. However, the red LED on the wireless socket remains illuminated for as long as it is switched on.
- The range reduces if the signal has to pass through ceilings, doors, windows or walls (environment dependent).
- The ON/OFF button in the "ALL" area can be used to switch all wireless sockets on or off at the same time.

GB

Tips

If the remote control is not working, check ...

- 1. ... whether the battery has been inserted correctly.
 - 2. ... whether the battery is empty; if the battery is empty, please replace it with an equivalent battery.
- Avoid getting the battery contacts wet.
 - Do not install the wireless socket in the immediate vicinity of transformers as these can affect the wireless connection.
 - Please do NOT exceed the maximum values (please refer to the specifications).
 - If possible, do not use the wireless socket for devices with a high switch-on voltage (motors, etc.).

If the wireless unit does not work, check ...

1. ... whether the selected socket is working properly.
2. ... whether the wireless unit is connected.

If you cannot detect a perceptible noise, the wireless socket is not connected to the remote control. Please repeat the "Commissioning" procedure.

3. ... whether the device to be connected is functional.
4. ... whether the inserted device is switched on - assuming it has an ON/OFF switch.

Maintenance

The device is maintenance-free, so please do not open the device. You will invalidate your warranty if you open up the device. Clean the outside with a soft, dry cloth or a brush.



Do not use any cleaning products that contain carbonic acid, benzene, alcohol or similar substances. Such substances attack the surface of the device and their vapours are also hazardous to health and explosive. Do not use any sharp-edged tools, screwdrivers, wire brushes or similar to clean the device.

Safety and maintenance instructions

- Make sure that all electrical connections, such as cable connections, comply with to the relevant policies.
- Attention! Do not overload power outlets and extensions, this can cause fire or an electric strike.
- If you are facing any trouble with using the device, or if you have any safety issues, please contact an expert.
- Keep out of the reach of children.
- Avoid hard impacts, this can lead to damaging the electronic circuits.
- Never replace damaged power leads yourself! Please remove the devices from the mains and contact a specialist company/dealer.
- Opening and repairing the device must be performed only by an authorized specialist.
- Wireless systems could be affected by phones, microwaves and other electronic devices that are operating within the 433.92 MHz field. Keep a minimum distance of at least 3 meters during the installation and operation of the device.

GB

Protecting the environment

At the end of its service life, this product must not be disposed of with the normal domestic waste. It must be taken to an assembly point for the recycling of electrical and electronic devices. This is indicated by the symbol on the product, the instruction manual and packaging. The materials and substances can be recycled according to their marking.



The reutilisation of recycled substances or other forms or recycling of old devices significantly helps the environment. Please contact your local authority for information regarding the relevant disposal points.



Declaration of Conformity

GB

PureLink
digital solutions

CE DECLARATION OF CONFORMITY

Rheine, 2016-11-14

We, the undersigned

PureLink GmbH
Von-Liebig-Str. 10
48432 Rheine
Germany

Declare that the product(s)

Product type: Description: Item no.:	Remote Socket Remote control for mains power socket RC-10
--	---

Is in compliance with the essential requirements and other relevant provisions of the following directives:

EN 300 220-2 V2.41, EN 301 489-1 V1.9.2, EN 301 489-3 V1.6.1

The R&TTE Directive 1999/5/EC (Article 3.1a and 3.2)
Note: The product will also comply with the test specification under 2014/53/EU (Article 3.1b & 3.2) from June 13, 2016, on conditions that the applicable harmonised standard(s) to be published are the same as above.

Test report number – 151201396SHA-001

Manufacturer/Authorized representative

Signature: 

Robin Cullen
Quality Manager

PureLink
digital solutions
Pörschkeplatz
Von-Liebig-Str. 10-10B33 Rheine
48432 Rheine
Tel. +49 (0) 5971 800 2990
www.purelink.de

PureLink
digital solutions

CE DECLARATION OF CONFORMITY

Rheine, 2016-12-22

We, the undersigned

PureLink GmbH
Von-Liebig-Str. 10
48432 Rheine
Germany

Declare that the product(s)

Product type: Description: Item no.:	Remote Socket Wireless remote control adaptor RCS-19GS, RCS-20GS, RCS-21GS, RCS-23GS
Rating and principal characteristics:	RCS-19GS: 220V - 50Hz 160VA Max.3400W µP29 RCS-20GS: 220V - 50Hz 16A Max.1700W µP25 RCS-21GS: 220V - 50Hz 160VA Max.3400W µP44 RCS-23GS: 220V - 50Hz 16A Max.1700W µP14 (With transmitter RCTE rated 3VDC 433.82MHz)

Is in compliance with the essential requirements and other relevant provisions of the following directives:

EN 300 220-2 V2.41, EN 301 489-1 V1.9.2, EN 301 489-3 V1.6.1

The R&TTE Directive 1999/5/EC (Article 3.1a and 3.2)
Note: The product will also comply with the test specification under 2014/53/EU (Article 3.1b & 3.2) from June 13, 2016, on conditions that the applicable harmonised standard(s) to be published are the same as above.

Low Voltage directive
2006/95/EC (valid until 18April, 2016)
2014/35/EU (effective from 20 April, 2016)

Test report numbers – 151201396SHA-001, 151201396SHA-002, 160200724SHA-001, 160200724SHA-002

Manufacturer/Authorized representative

Signature: 

Robin Cullen
Quality Manager

PureLink
digital solutions
Pörschkeplatz
Von-Liebig-Str. 10-10B33 Rheine
48432 Rheine
Tel. +49 (0) 5971 800 2990
www.purelink.de

Manufactured for PureLink GmbH, Von-Liebig-Str. 10, 48432 Rheine, +49(0)59718002990, www.purelink.de

Imported for Claus GmbH, Sigsfeldstraße 4, 45141 Essen, www.mumbi.de



mumbi[®]

Claus GmbH
Sigsfeldstr. 4
45141 Essen

www.mumbi.de